

Delekatalog

Beta Rev-80

2006

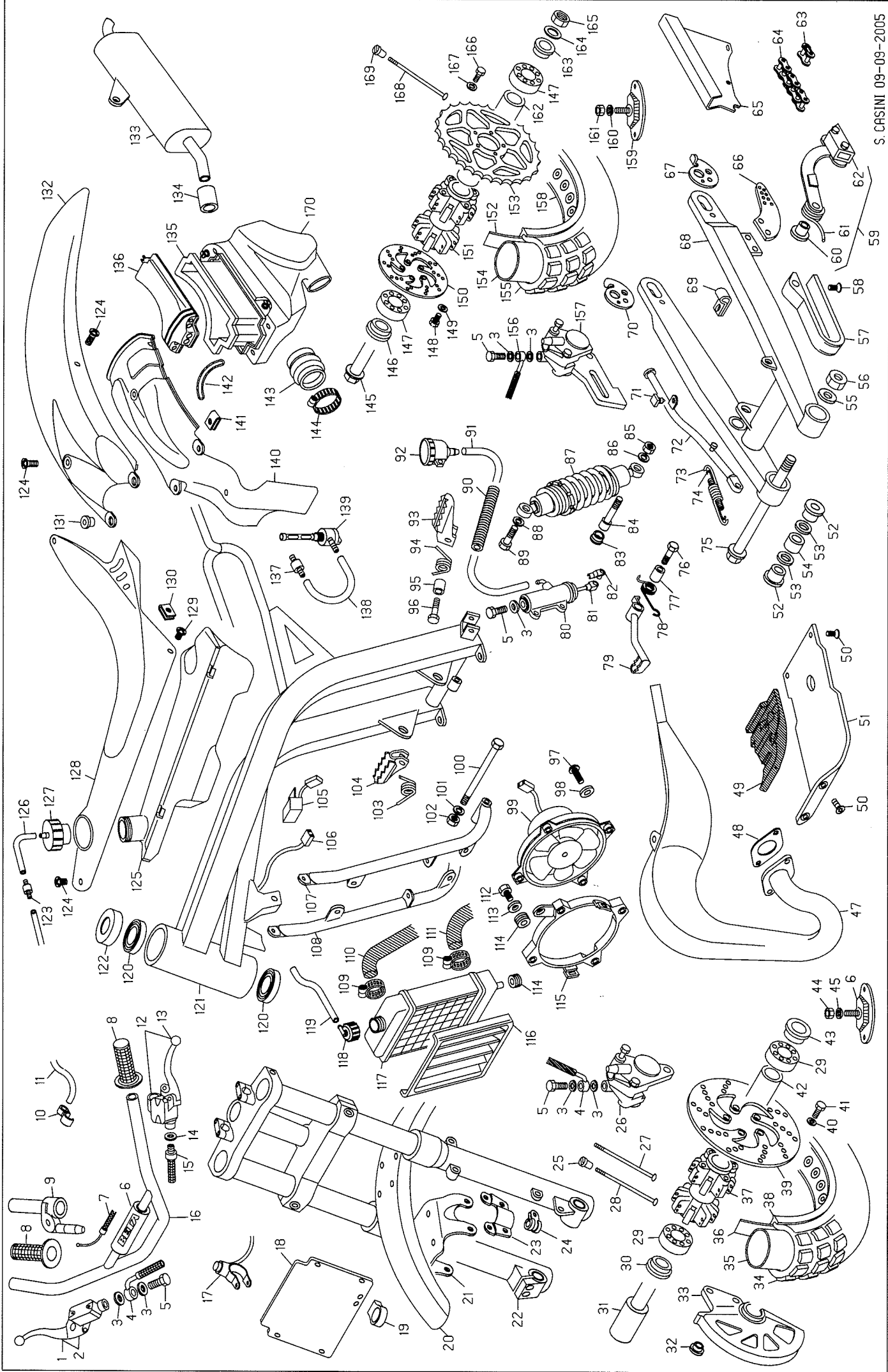



FRAME

REV-80-06

CODE 38-35214

FROM FRAME NR. xxxxxx

ES-TE234

N. CODICE	DESCRIZIONE	N. CODICE	DESCRIZIONE	N. CODICE	DESCRIZIONE	N. CODICE	DESCRIZIONE	
1	21-27058	FRONT BRAKE LEVER ONLY	56	13-21150	NUT	111	29-15735	RADIATOR PIPE
2	21-02151	FRONT BRAKE LEVER	57	29-10090-0-52	SLIDING BLOCK	112	11-46100	BOLT 5x8
3	16-50510	COPPER WASHER 10x15x1	58	31-30500	SCREW 6x12	113	27-36000	WASHER
4	29-09124	FRONT BRAKE HOSE	59	29-25970	SLIDING BLOCK ASSY	114	28-91500	SILENT BLOCK
5	11-65041	SPEC. BOLT BRAKE TUBE	60	13-46314	SPACER	115	28-98012-0-59	ELECTRIC FUN BRACKET
6	16-23593-0-57	HEADLEBAR RUBBER	61	22-81111	SPRING	116	16-45538-1-67	RADIATOR GRILL
7	29-21977-0-52	THROTTLE CABLE	62	16-22500	RUBBER SLIDING BLOCK	117	27-23641	RADIATOR
8	22-18531	GRIPS	63	22-11180	CONNECTION LINK	118	29-01821	RADIATOR PLUG
9	12-55091	THROTTLE ONLY	64	12-08050	CHAIN	119	29-15811	PIPE 5x9
10	28-98600	BEATHER PIPE BRACKET	65	12-84771-0-52	CHAINGUARD	120	12-98300	CONICAL BEARING 20x42x15
11	29-15811	TUBE 5x9	66	25-98955	SPROCKET PROTECTION	121	29-11557-0-33	FRAME
12	21-02421	CLUTCH LEVER	67	29-11891	LH CHAIN ADJUSTER	122	25-98670	PROTECTION BEARING
13	21-27081	CLUTCH LEVER ONLY	68	15-49632	SWINGING ARM	123	31-02170	TANK VALVE
14	16-50510	COPPER WASHER	69	15-14653	CLAMP	124	31-30520	SCREW 6x16
15	29-09094	CLUTCH TRANSMISSION	70	29-11892	RH CHAIN ADJUSTER	125	28-06071	FUEL TANK
16	22-20457-0-33	HANDLEBAR	71	16-29490	RUBBER STAND	126	29-15811	PIPE 5x9
17	18-84983	SWITCH	72	12-39972	STAND	127	29-00525-0-59	FUEL TANK PLUG
18	22-28853-8	HEADLIGHT MASK ASSY	73	22-47022	STAND SPRING	128	12-88517-8	FUEL TANK COVER ASSY
19	25-25220	PLATE	74	22-47019	STAND SPRING	129	31-30520	SCREW 6x16
20	25-15189-0-97	FRONT FENDER	75	25-55725	S/ARM SPINDLE	130	25-60810	PLATE FIXING M6
21	28-96270	FRONT FENDER BRACKET	76	11-55450	BOLT 8x30	131	13-62000	SPACER
22	15-08134	FRONT FORK	77	13-46313	SPACER BRAKE LEVER	132	25-19583-8-59	REAR FENDER ASSY
23	28-95653	BRACKET	78	22-80510	SPRING BRAKE LEVER	133	28-91779	SILENCER
24	25-23006	CLAMP	79	25-28092	BRAKE LEVER	134	22-12120	RUBBER SLEEVE
25	23-10060	NIPPLES	80	25-91182	REAR BRAKE PUMP	135	15-25205	AIR FILTER
26	25-03047	FRONT BRACKE PLIERS	81	10-84093	REAR BRAKE ROD	136	12-73181	FILTER COVER
27	27-23834	FRONT SPOKE 3x250	82	28-93130	BRAKE ROD LOCKING PLATE	137	15-24651	GASOLINE FILTER
28	27-23834	FRONT SPOKE 3x252	83	29-10593	RUBBER PLUG	138	29-15811	PIPE 5x9
29	12-94010	BALL BEARING 15x35x11	84	31-65510	SCREW 10x55	139	27-81082	PETCOCK
30	13-85766	WHEEL HUB RH SPACER	85	13-19010	NUT	140	25-24655-0-59	WHEEL HOUSE
31	25-55693	FRONT WHEEL AXLE	86	27-54000	WASHER	141	25-60310	PLATE FIXING M6
32	13-55240	FRONT DISK COVER SPACER	87	10-03723	SHOCK ABSORBER	142	14-40040	ELECTIC RUBBER
33	12-88071-1-33	DISK BRAKE COVER SPACER	88	27-54000	SELF-BLOCKING NUT	143	22-13576	RUBBER SLEEVE
34	12-79400	TIRE 2,75x21	89	11-63000	BOLT 10x50	144	15-15360	CLAMP 25-45
35	12-16410	TUBE 2,75x21	90	22-55535	SPRING	145	25-55815	REAR WHEEL AXLE
36	15-38200	FLAP 21x25	91	29-15862	TUBE 3x8	146	13-85767	WHEEL HUB RH SPACER
37	22-07243	FRONT HUB	92	28-05100	BRAKE OIL TANK	147	12-94010	BALL BEARING 15x35x11
38	12-42864	FRONT RIM 21	93	25-32530	LH FOOTREST	148	11-49010	BOLT 6x20
39	13-39278	FRONT BRAKE DISK	94	22-62020	LH FOOTREST SPRING	149	27-39400	WASHER
40	11-49010	WASHER 8 GROWER	95	13-46530	SPACER	150	13-39414	REAR BRAKE DISK
41	27-39400	BOLT 8x8	96	11-55700	BOLT 8x45	151	22-08042	REAR HUB
42	13-62704	WHEEL HUB INNER SPACER	97	31-27510	SCREW 4x20	152	15-36000	CLAMP 17-18x25
43	13-85765	WHEEL HUB LH SPACER	98	27-34500	WASHER	153	12-89587	REAR SPROCKET
44	13-17000	NUT	99	14-01040	ELECTRIC FAN	154	12-18460	TUBE 4,00x18
45	27-48000	WASHER 8 GROWER	100	11-57990	BOLT 8x180	155	12-81520	TIRE 4,00x18
46	15-17500	TIRE FASTENER	101	27-49500	WASHER 8x18	156	29-09125	REAR BRAKE HOSE
47	22-03344	MUFFLER	102	13-17020	NUT 8 SELF BLOCKING	157	25-03033	REAR BRAKE PLIERS
48	16-80321	COPPER	103	22-62010	FOOTREST SPRING	158	12-42866	REAR RIM 18
49	16-23342	BUMPER RUBBER	104	29-32520	RH FOOTREST	159	15-17550	TIRE FASTENER
50	31-63930	SCREW 8x20	105	27-28092	REGULATOR	160	27-48000	WASHER 8 GROWER
51	12-32172	BUMPER	106	18-01851	ELECTRIC EQUIPMENT	161	13-17000	NUT 8x8
52	13-49201	SPACER	107	29-11562-0-33	LH CONNECTING FRAME ROD	162	13-62714	INNER REAR HUB SPACER
53	10-41195	DUST COVER RING	108	29-11561-0-33	RH CONNECTING FRAME ROD	163	13-85769	WHEEL HUB LH SPACER
54	11-26451	AXLE BOX	109	15-15230	CLAMP 14-24	164	27-55600	WASHER 8x24
55	27-55600	WASHER	110	29-15736	RADIATOR PIPE	165	13-21150	NUT 12x1,25

SUPPLEMENTARY PARTS LIST

12-43060 SPARK KEY
 13-3816-1 FRONT FENDER DECALS
 13-34063 DECALS SET -ASSY-
 13-34063-3 REAR FENDER DECALS-
 13-34052-4 FUEL TANK COVER DECALC
 13-34062-5 HEADLIGHT MASK DECALC
 13-34052-6 COMPLETELY DECALS
 27-02556-0-57 FRONT WHEEL
 27-04824-0-57 REAR WHEEL
 37-42862 ENGINE

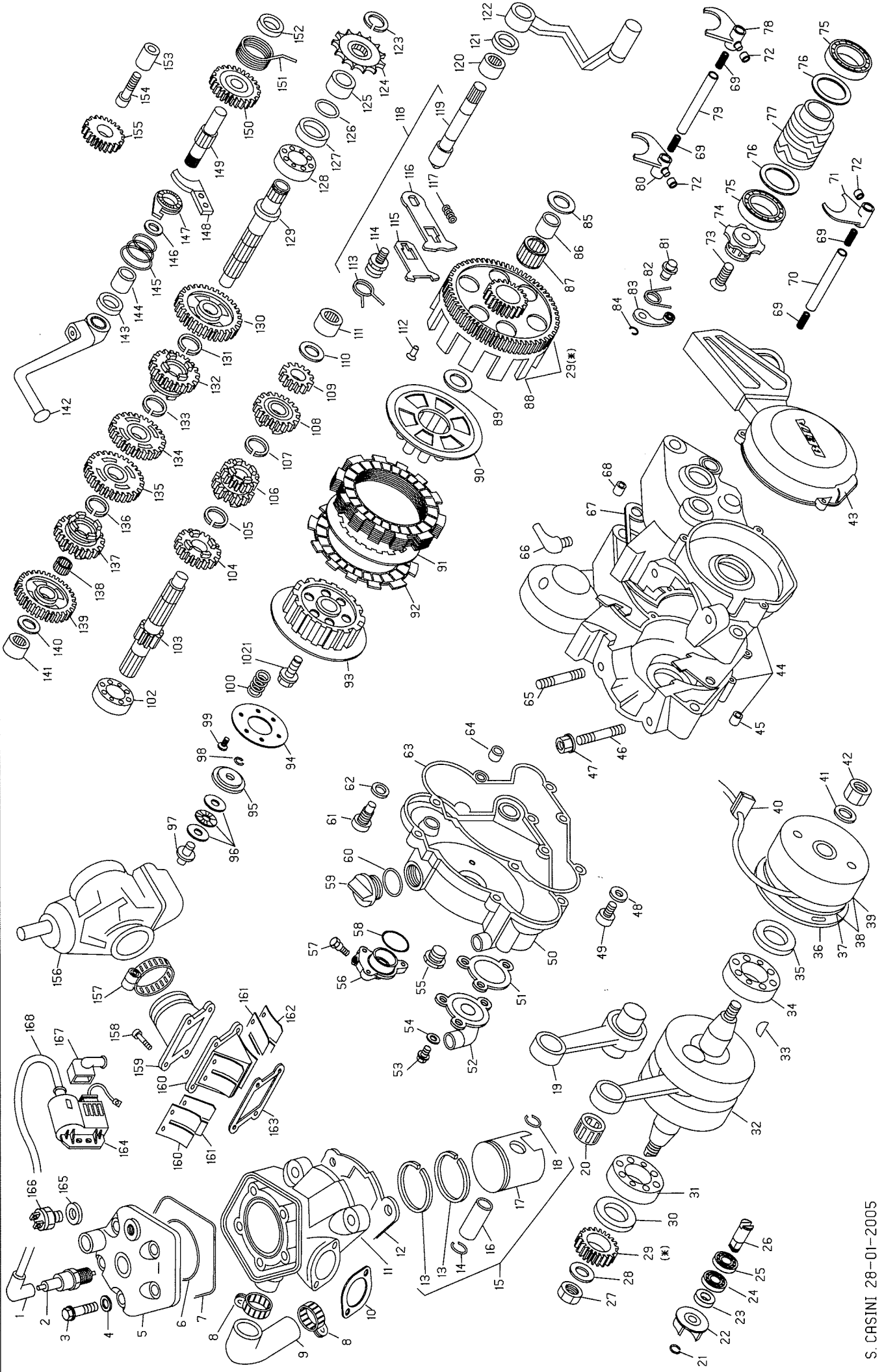



ENGINE REV-80-3[^]VERS.

CODE 37-42862

FROM ENGINE NR. BKT80 300499

ES-ME232

N. CODE	DESCRIPTION	N. CODE	DESCRIPTION	N. CODE	DESCRIPTION
1	27-13513 SPARK PLUG PROTECTOR	60	10-66340 SEAL 16x3	119	11-22200 NEEDLE BEARING 12x18x12
2	12-25200 SPARK PLUG	61	31-88500 SCREW	120	10-12010 SELECTOR SHAFT
3	11-52425 SPECIAL BOLT	62	16-49100 GASKET 8x12x0.5	121	10-47500 OIL SEAL 12x20x5
4	27-45100 COPPER WASHER 7x12x0.5	63	16-71520 CLUTCH COVER GASKET	122	21-21220 SHIFT LEVER
5	29-12025-0-57 CYLINDER HEAD	64	16-37010 DOWEL 9x15	123	28-25410 SEEGER AS 20E
6	10-67110 SEAL VYTON 53.70x57.26x1.78	65	25-98050 STUD BOLT 8x44	124	25-61050 SPROCKET Z.10
7	10-66960 SEAL 94.97x98.53x1.78	66	27-23470 BREATHER PIPE HOSE	125	13-55250 SPROCKET SPACER
8	15-15230 CLAMP 14/24	67	16-55030 CRANKCASE GASKET	126	10-66350 SEAL 18.77x1.78
9	29-15910 COOLING HOSE	68	16-41530 DOWEL 17	127	10-64700 OIL SEAL 26x35x7
10	16-80321 GASKET	69	22-65015 SPRING	128	12-98000 BALL BEARING 20x42x12
11	12-52463-0-57 CYLINDER	70	25-51011 SELECTOR PIN	129	LAYSHAFT
12	16-61750 CYLINDER CRANKCASE GASKET	71	15-64031 SELECTOR FORK 5-6	130	18-52030-8 2ND GEAR - LAYSHAFT
13	28-60180 PISTON RING	72	11-29035 SELECTOR FORK BUSH	131	28-25410 SEEGER AS 20E
14	10-42010 CIRCLIP	73	31-30510 SCREW 6x30	132	18-67142-8 6TH GEAR - LAYSHAFT
15	25-80270-8 COMPL. PISTON	74	12-19122 TOP CAM	133	28-25410 SEEGER AS 20E
16	28-93620 PISTON PIN	75	12-99405 BALL BEARING 25x37x7	134	18-61500-8 3RD GEAR - LAYSHAFT
17	25-80270 PISTON	76	27-73695 SPECIAL WASHER	135	18-64100-8 4TH GEAR - LAYSHAFT
18	10-42010 CIRCLIP	77	12-19113 CAM	136	28-25410 SEEGER AS 20E
19	11-03716-8 CONNECTING ROD ASSY	78	15-64012 SELECTOR FORK 1-4	137	18-66442-8 5TH GEAR - LAYSHAFT
20	16-11500 NEEDLE BEARING	79	25-51021 SELECTOR PIN	138	16-12650 NEEDLE BEARING
21	28-22660 SEEGER 9E	80	15-64011 SELECTOR FORK 2-3	139	18-43023-8 1ST GEAR - LAYSHAFT
22	31-21831 PUMP FAN	81	25-54430 PIN	140	27-60500 WASHER 11x25x1
23	10-44610 OIL SEAL 10x18x4	82	22-39580 LOCATING SPRING	141	11-22250 NEEDLE BEARING 12-19-12
24	12-93400 SCH. BALL BEARING 10x19x5	83	21-17150 LOCATING LEVER	142	21-55153 KICKSTARTER LEVER
25	12-93390 BALL BEARING 10x19x5	84	28-22700 SEEGER 10E	143	10-52010 OIL SEAL 14x24x7
26	10-27750 WATER PUMP SHAFT	85	27-71100 SPECIAL WASHER 17x30x1.5	144	11-31020 SINTERED BUSH
27	13-28951 SPECIAL NUT 14x1.25x5	86	11-27120 STEEL BUSH	145	22-36570 CONICAL SPRING
28	27-61550 WASHER 14x20x1	87	16-17280 NEEDLE BEARING 21.25.17	146	27-61550 WASHER 14x20x1
29	29-07302-8 PRIMARY DRIVE	88	12-20770 CLUTCH HOUSING	147	22-14090-8 KICKSTARTER SLEEVE
30	10-64110 OIL SEAL VYTON 20x35x6	89	27-71100 SPECIAL WASHER 17x30x1.5	148	25-57945 KICKSTARTER PLATE
31	12-99022 BALL BEARING 20x52x15	90	12-29593 PRESSURE PLATE	149	10-15120-8 STARTER SHAFT
32	10-00682 CRANKSHAFT	91	13-38130 CLUTCH PLATE	150	18-14620-8 STARTER GEAR
33	12-46000 WOODRUFF KEY	92	12-43210 STEEL CLUTCH PLATE	151	22-78250 KICKSTARTER SPRING
34	12-99022 BALL BEARING 20x52x15	93	29-09613 CLUTCH CENTER	152	13-48080 SPACER
35	10-64110 OIL SEAL VYTON 20x35x6	94	13-42050 SPRINGS BLOCKING PLATE	153	25-43910 DRIVE GEAR PIN
36	25-60163 STARTOR PLATE	95	28-16820 CLUTCH DRIVE PIN HOLDER	154	31-81050 SCREW 6x15
37	28-97807 FLYWHEEL STATOR	96	16-11250 NEEDLE BEARING 6x19x2	155	18-67810-8 GEAR
38	31-03263 ELECTRIC FLYWHEEL	97	25-52391 CLUTCH DRIVE PIN	156	12-05063 CARBURETOR
39	27-00359 FLYWHEEL ROTOR	98	28-22610 SEEGER 6E	157	15-15370 CLAMP
40	16-33560 GROMMET	99	31-34400 SCREW 6x20	158	31-34510 SCREW 6x20
41	27-52500 SPECIAL WASHER	100	22-65093 CLUTCH SPRING	159	27-23051 INLET MANIFOLD
42	13-25100 SPECIAL NUT	101	11-59150 BALL BEARING 17x40x9	160	31-02140 REED VALVE
43	12-70063-0-57 MAGNETO COVER	102	12-95500 BALL BEARING 17x40x9	161	25-59670 VALVE'S BLADE
44	12-06227 CRANKCASE	103	10-23520-8 LAYSHAFT	162	21-15360 VALVE'S PLATE
45	16-41510 DOWEL 12	104	18-36412-8 5ND GEAR - LAYSHAFT	163	16-92550 VALVE'S GASKET
46	25-98050 STUD BOLT 8x41	105	28-24950 SEEGER 17 SW	164	11-20638 H.T. COIL
47	13-17121 SPECIAL NUT M8	106	18-37652-8 3RD/4TH GEAR - MAINSHAFT	165	16-49500 GASKET 8x20x1
48	16-50511 COPPER WASHER 10x15x2	107	28-24950 SEEGER 17 SW	166	29-11960 THERMOSTAT
49	11-58020 SPECIAL BOLT	108	18-38742-8 6TH GEAR - MAINSHAFT	167	12-30460 H.T. COIL RUBBER
50	12-62095-0-33 CLUTCH COVER	109	18-34110-8 2ND GEAR - MAINSHAFT	168	12-08280 COIL SCREENED CABLE
51	16-74930 GASKET	110	27-60500 SPECIAL WASHER		
52	12-67941-0-33 PUMP COVER	111	11-22250 NEEDLE BEARING 12x19x12		
53	31-30510 SPECIAL BOLT	112	27-31640 RIVET 5x9		
54	27-40490 COPPER WASHER 6x10	113	22-72030 SELECTOR SPRING		
55	29-10030 WARNING OIL PLUG	114	25-54410 P.I.N FOR RETURNING SPRING		
56	12-91895-0-33 CLUTCH PUMP COVER	115	31-20980-8 ROLLING SHIFT CONTR. FORK		
57	31-83530 SPECIAL SCREW	116	31-20970-8 SHIFT CONTROL FORK		
58	10-66750 OIL SEAL	117	22-68010 SHIFT CONTROL SPRING		
59	29-09600 FEEDING OIL PLUG	118	10-12010-8 SELECTOR SHAFT ASSY		

SUPPLEMENTARY PARTS LIST

12-00686-8	GEARBOX
22-05070-8	COMPLETE KICKSTARTER
28-06887-8	OIL SEAL SET
28-08070-8	GASKET SET